

PRCV Series	<b>PRCV-FP</b>	<b>PRCV-STH1</b>	<b>PRCV-STH2</b>	<b>PRCV-STHP</b>
<b>Size Range</b>	2 in to 42 in	6 in to 24 in	6 in to 24 in	6 in to 24 in
<b>Design Standard</b>	API-6D / ASME B16.5 API 6FA	API-6D / ASME B16.5 API 6FA	API-6D DIM / ASME B16.5 API 6FA	ASME B16.5 & B16.34 API 6FA / PED Compliant
<b>ANSI Range</b>	150 – 1500 ANSI	150 – 1500 ANSI	150 – 1500 ANSI	150 – 1500 ANSI
<b>End Connections</b>	RFFE, Weld, RTJ, Combo	RFFE, Weld, RTJ, Combo	RFFE, Weld, RTJ, Combo	RFFE, Weld, RTJ, Combo
<b>Trim Type</b>	Full Port	Stealth Trim Level 1	Stealth Trim Level 2	Stealth Trim High Performance
<b>Performance Trim Technology</b>	N/A	Upstream Var Diffuser Upstream Fixed Diffuser	Upstream Var Diffuser Downstream Var Diffuser Upstream Fixed Diffuser Drilled Hole Ball Side Exit	Upstream Var Diffuser Ball Diffuser Plates Ball Side Exit
<b>Relative Capacity</b>	Maximum Capacity	Very High Capacity	Very High Capacity	High Capacity
<b>Max Noise Attenuation <i>Forward Flow</i></b>	N/A	7 dBA	15 dBA	25 dBA
<b>Max Control <math>\Delta P</math> <i>Forward Flow</i></b>	FULL ANSI $\Delta P$	1000 psid	1000 psid	1440 psid
<b>Max Control <math>\Delta P</math> <i>Reverse Flow</i></b>	FULL ANSI $\Delta P$	1000 psid	1000 psid	1440 psid
<b>Max Shutoff <math>\Delta P</math></b>	FULL ANSI $\Delta P$	FULL ANSI $\Delta P$	FULL ANSI $\Delta P$	FULL ANSI $\Delta P$
<b>Compatible Buried Applications</b>	YES	YES	YES	YES
<b>Max Range-Ability <i>Forward Flow</i></b>	100:1	300:1	300:1	200:1
<b>Min Control Cv <i>Forward Flow</i></b>	1.0% Max Cv	0.33% Max Cv	0.33 % Max Cv	0.5% Max Cv
<b>Min Control Cv <i>Reverse Flow</i></b>	1.0% Max Cv	1.0% Max Cv	0.50 % Max Cv	0.5% Max Cv
<b>Max Control Cv</b>	90% Max Cv	85% Max Cv	85% Max Cv	85% Max Cv
<b>Shutoff</b>	API 6D Bubble Tight	Class VI	Class V	Class V
<b>Seats</b>	2X Seats Soft Seats Std Double Piston Effect Metal Seats Optional	2X Seats Soft Seats Std Double Piston Effect Metal Seats Optional	1X Upstream Soft Seats Std Double Piston Effect Metal Seats Optional	1X Upstream Metal Seats Std Double Piston Effect
<b>Compatible Actuators</b>	VRG RHPA-DA VRG RHPA-SR Electric Actuators Other Manufacturers	VRG RHPA-DA VRG RHPA-SR Electric Actuators Other Manufacturers	VRG RHPA-DA VRG RHPA-SR Electric Actuators Other Manufacturers	VRG RHPA-DA VRG RHPA-SR Electric Actuators Other Manufacturers
<b>Final Assembly and Test Country of Origin (Valve Trims)</b>	USA	USA	USA	ITALY

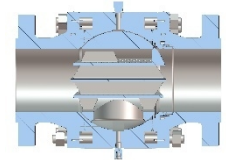
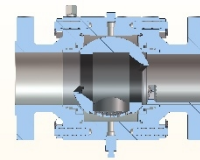
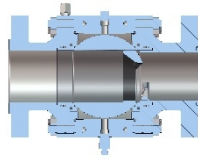
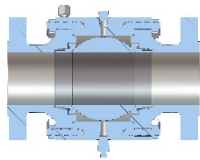

PRCV Series	<b>PRCV-FP</b>	<b>PRCV-STH1</b>	<b>PRCV-STH2</b>	<b>PRCV-STHP</b>
Base Platform	T31 / 55 / B5	55 / B5	55 / B5	VP
Base Manufacturer	Delta / Cameron / Grove	Delta / Grove	Delta / Grove	Valpres
Control Valve Specs	Per VRG PRCV Specifications	Per VRG PRCV Specifications	Per VRG PRCV Specifications	Per VRG PRCV Specifications
Body (Forged)	A350 LF2	A350 LF2	A350 LF2	A350 LF2
Stem	AISI 4140 + 1.0 mil ENP	AISI 4140 + 1.0 mil ENP	AISI 4140 + 1.0 mil ENP	17-4PH SS
Ball	A350 LF2 + 1.0 mil ENP + PRCV Control Specification Moly Sulfide Coating Baked & Polished ** N/A Type T31	A350 LF2 + 1.0 mil ENP + PRCV Control Specification Moly Sulfide Coating Baked & Polished	A350 LF2 + 1.0 mil ENP + PRCV Control Specification Moly Sulfide Coating Baked & Polished	A350 LF6 6.0 mil TCC PRCV Control Specification
Lubrication	Mobil SHC220	Mobil SHC220	Mobil SHC220	Mobil SHC220
Stem Seal	VITON O-RINGS, or NYLON or PTFE U-Cups	VITON O-RINGS, or NYLON or PTFE U-Cups	VITON O-RINGS, or NYLON or PTFE U-Cups	PTFE V-PACK
Stem Injection**	Stem Inject & Opposing Stem Relief Port	Stem Inject & Opposing Stem Relief Port	Stem Inject & Opposing Stem Relief Port	Stem Inject & Opposing Stem Relief Port
Body Drain**	Rotate 90° From Stem	Rotate 90° From Stem	Rotate 90° From Stem	Rotate 90° From Stem
Seat Ring**	A350 LF2 50% Seat Springs Wave Spring – Type T31	A350 LF2 50% Seat Springs	A350 LF2 50% Seat Springs	Al182 F6A 6.0 mil TCC 50% Seat Springs
Seat Seal	VITON O-Ring Insert DEVLON O-Ring Insert NYLON Molded Insert	VITON O-Ring Insert DEVLON O-Ring Insert	VITON O-Ring Insert DEVLON O-Ring Insert	N/A - Metal Seated
Seat Injection	Upstream/Downstream Buttonhead ** N/A Type 54	Upstream/Downstream Buttonhead	Upstream/Downstream Buttonhead	Upstream Buttonhead
O-Rings	VITON	VITON	VITON	VITON AED
Firesafe Seals	GRAPHITE	GRAPHITE	GRAPHITE	GRAPHITE
Upstream Var. Diffuser	--	17-4PH SS	17-4PH SS	17-4PH SS
Downstream Var. Diffuser	--	--	17-4PH SS	17-4PH SS
Fixed Diffuser	--	17-4PH SS	17-4PH SS	--
Ball Diffuser Plates	--	--	--	17-4PH SS
Ball Side Exit Hole	--	--	YES	YES
Exterior Coating	SP-10 / VRG Zinc Primer / VRG Epoxy Topcoat (WHITE) *Customer Specific Coatings Available	SP-10 / VRG Zinc Primer / VRG Epoxy Topcoat (WHITE) *Customer Specific Coatings Available	SP-10 / VRG Zinc Primer / VRG Epoxy Topcoat (WHITE) *Customer Specific Coatings Available	SP-10 / VRG Zinc Primer / VRG Epoxy Topcoat (WHITE) *Customer Specific Coatings Available